

	1		2		3		4		5		6	
	Test Plate		Fit To Test Plate Fringes		Clear Aperture	Surface Quality						
	Radius	Tolerance	Power frngs	Irrigularity frngs	∅ mm	Central zone	Outer zone					
R1	-800	±0.4	3	1	47	60-40	60-40					
R2	+48.74	±0.03	3	1	47	60-40	60-40					

Notes:

- 1- Manufacture per MIL-O-13830.
- 2- Polish Surfaces Marked 'P'.
- 3- Chamfer Edges 0.2*45°.
- 4- Centering Error: 1 arc min.
- 5- EFL = 80.11 mm.
- 6- Coating R1, R2: Broad-band Multi-layer AR Coating
 $R(\text{avg}) < 0.5\%$ from 400-750 nm.
 According per MIL-C-675.

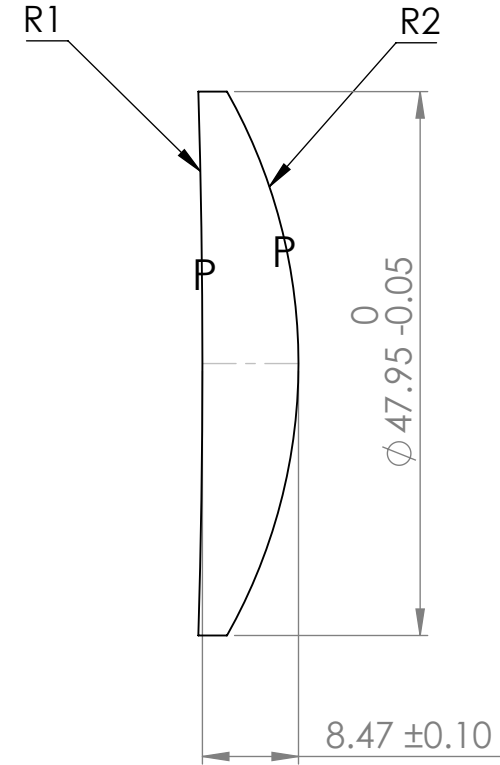

Optics R&D Center

MATERIAL		TITLE	
LAK21		Lens	
PROJECT		DWG NO.	
DESIGNED		SCALE	QUANTITY
DATE	ALL DIMENTIONS ARE MILIMETER UNLESS OTHER WISE STATED		

	1		2		3		4	5	6
	Test Plate		Fit To Test Plate Fringes		Clear Aperture	Surface Quality			
	Radius	Tolerance	Power frngs	Irrigularity frngs	∅ mm	Central zone	Outer zone		
R1	Plano				49.8	20-10	40-20		
R2	Plano				49.8	20-10			

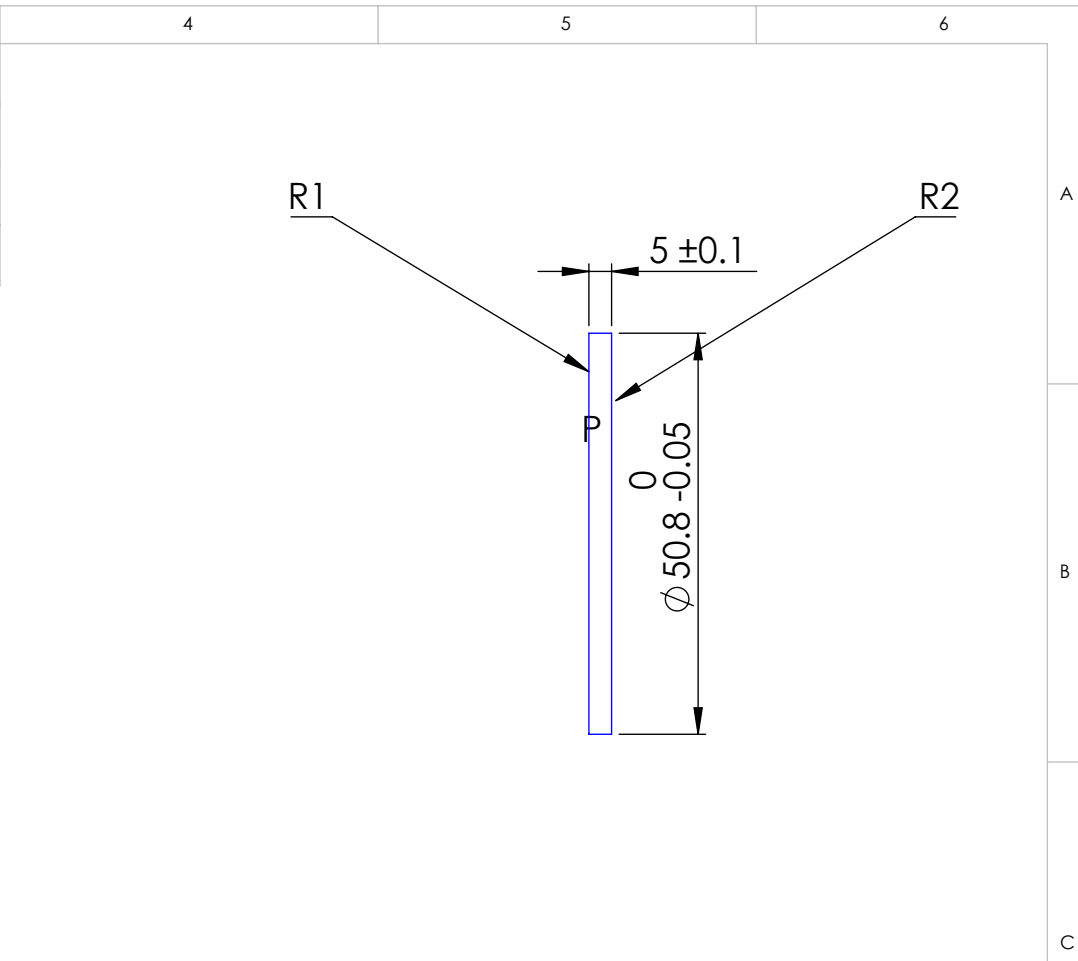

Notes:

- 1- Manufacture per MIL-O-13830.
- 2- Polish Surface Marked 'P'.
- 3- Surface Flatness: $\leq \lambda/4$ @ 633 nm.
- 4- Coating R1: Aluminium with Protected Layer MgF_2 .
- 5- Parallelism: < 3 arc min.
- 6- Back Surface: Fine Ground.

		Optics R&D Center	
MATERIAL		TITLE	
BK7		Mirror	
PROJECT		DWG NO.	
DESIGNED		SCALE	QUANTITY
DATE	ALL DIMENTIONS ARE MILIMETER UNLESS OTHER WISE STATED		

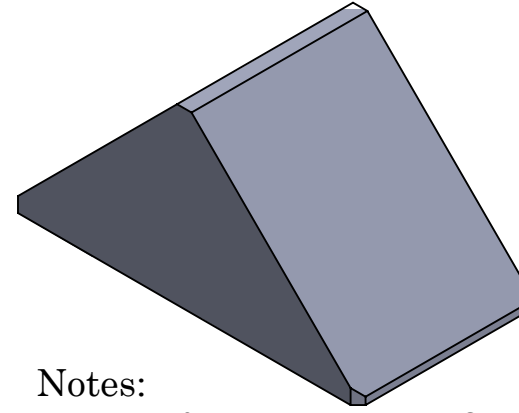
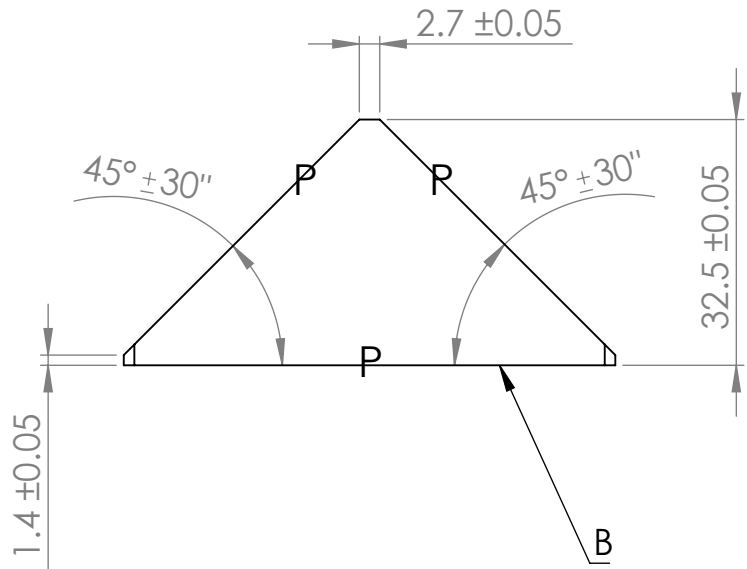
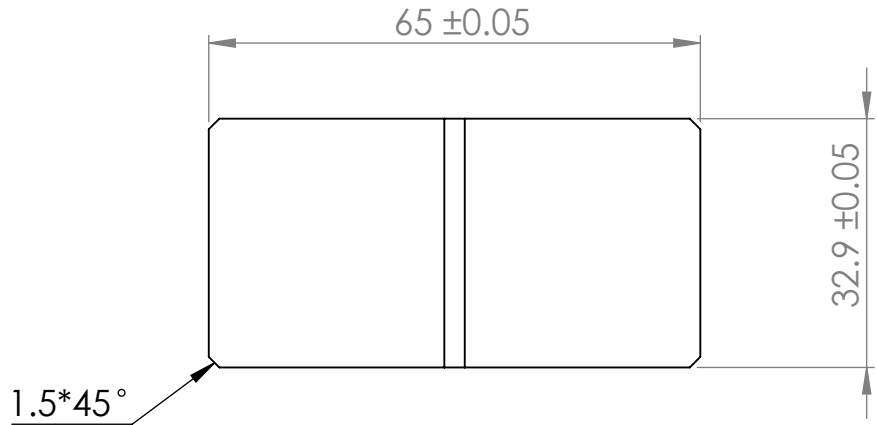

Notes:

- 1- Manufacture per MIL-O-13830.
- 2- Polish Surfaces Marked 'P'.
Flat within 3 Fringes, Irregularity 1 Fringe.
- 3- Polish Surface Quality 60-40.
- 4- Chamfer Sharp Edges 0.2*45°.
- 5- Pyramid Error: max 2' (2 min).
- 6- Coating: Broad-band Multi-layer AR Coating on Surface Marked 'B'.
R(avg) < 0.5 % from 400-750 nm.
According per MIL-C-675.

		Optics R&D Center	
MATERIAL		TITLE	
BK7		Right-Angle Prism	
PROJECT			DWG NO.
DESIGNED		SCALE	QUANTITY
DATE	ALL DIMENTIONS ARE MILIMETER UNLESS OTHER WISE STATED		

	1		2		3		4		5		6	
	Test Plate		Fit To Test Plate Fringes		Clear Aperture	Surface Quality						
	Radius	Tolerance	Power frngs	Irrigularity frngs	∅ mm	Central zone	Outer zone					
R1	Plano		3	1	34.5	10-5	20-10					
R2	Plano		3	1	34.5	10-5	20-10					

Notes:

- 1- Manufacture per MIL-O-13830.
- 2- Polish Surfaces Marked 'P'.
- 3- Chamfer Both Sides max 0.2*45°.
- 4- Parallelism: max 1 arc min.

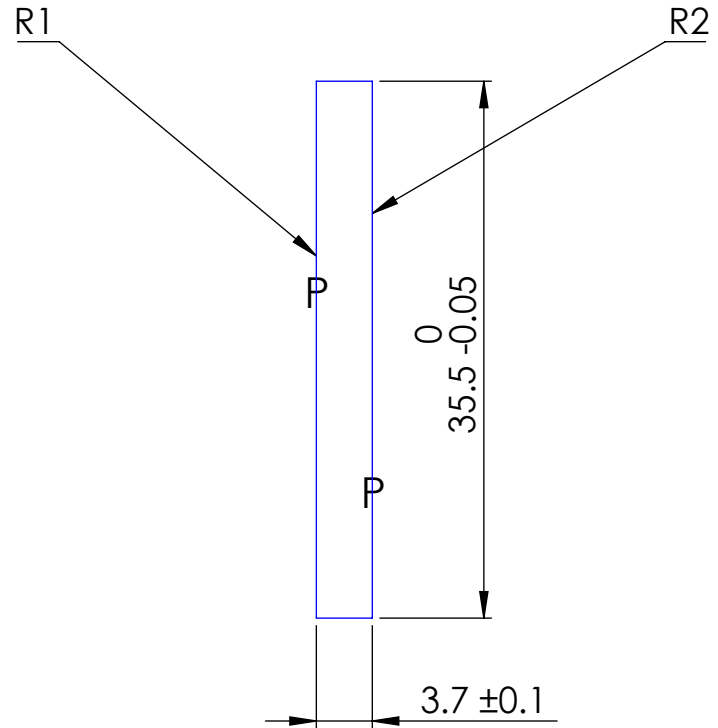

Optics R&D Center

MATERIAL		TITLE	
BK7		Reticle Substrate	
PROJECT			DWG NO.
DESIGNED		SCALE	QUANTITY
DATE	ALL DIMENTIONS ARE MILIMETER UNLESS OTHER WISE STATED		